

PROJECT MANAGEMENT

**A systematic approach to your projects:
Better coordination of plans and documents**

ACCURATE, UP-TO-DATE INFORMATION AT YOUR FINGERTIPS

Manage your projects more efficiently with ArchiDATA's Project Management Module. This high-performance tool allows you to:

- ▶ Set-up quickly construction or renovation projects by distributing plans online
- ▶ Create virtual work teams during the conception and execution of projects
- ▶ Maintain centralized records of construction projects
- ▶ Provide coordination tools for fast track and "slow track" projects
- ▶ Provide online management of project phases and professionals
- ▶ Provides tendering management tool

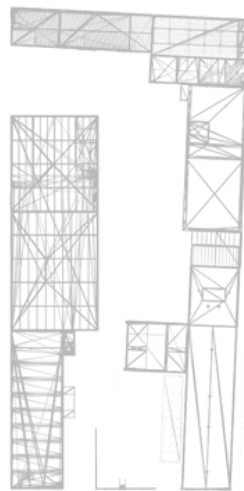

BENEFITS

Users have recognized the following advantages to using the Project Management Module:

- ▶ Reduces mistakes due to poor communication between participants during planning and construction
- ▶ Reduces the costs of printing and distribution plans
- ▶ Coordinates projects, both internally and externally more efficiently
- ▶ Recovers information following employee turnover
- ▶ Keeps a history of all construction projects

ARCHIDATA MODULES

By combining technology and service, ArchiDATA facilitates your property management with the following tools:

- Virtual Plan Room
- Space Management
- Facilities Management
- Leasing Management
- Portfolio Management
- Project Management
- Scenario Planning Management
- Plan Scanning
- CertiPLAN

ABOUT ARCHIDATA

Founded in 1995, ArchiDATA is a company that specializes in the development of Web-based solutions for plan (paper or CAD), space and building management. ArchiDATA offers a centralized archiving system for plans and documents accessible by all professionals involved in property management and construction.

The ArchiDATA platform and modules are designed to interface with the client's existing systems. It is a global solution for every stage of the property life cycle to increase portfolio performance for all aspects of real estate, including asset, leasing and property management and construction.

To date, more than 140 million square feet are managed using our solution.

